



The Defender R30 camera integrates long range OIS visible zoom lens in an agile & robust PT system, is well designed to provide early detection and vast area coverage in various scenarios like coastal, border, aviation or counter-UAV surveillance. Powered by industry leading AI ISP and in-house machine learning algorithms, the camera acts faster with a variety of intelligent detections.

Features

Exceptional Imaging Performance

1/1.8" 4MP Sony Starvis sensor with Vmage AI ISP, presents crisp, clear images in even the most challenging lighting conditions.

Vast Area Coverage

6-300mm 50x visible zoom lens, enhance your awareness and detection range.

Fast Detection with Machine Learning

Act quicker with intelligent analytics that alert you in real-time of critical events. R30 supports various machine learning detections of fire/smoke/human/vehicle/vessel or anomalies to help you identify potential threats.

Rugged Design for Tough Environments

Robust top-load structure with IP66/TVS 6KV/lightning/surge/voltage transient protection, R30/R30L is designed for various extreme outdoor weather conditions.

Technical Specs

Visible Camera				
Image Sensor	1/1.8" STARVIS progressive scan CMOS			
Resolution	2688 x 1520, 4MP			
Lens	15-775mm, 52x motorized zoom, F2.8-8.2 Field of view: 29.1°x 16.7°(H x V)-0.5°x 0.3°(H x V) Near focus distance: 1-10m Zoom speed: <7s(W-T) Focus modes: Semi-auto/Auto/Manual/One-push			
Min. illumination	Color: 0.0005Lux, B/W: 0.0001Lux, AGC&AI-NR ON, F2.8			
Electronic Shutter Speed	1/1-1/30000s			
Noise Reduction	2D/3D/AI-NR			
Image Stabilization	EIS & OIS			
Day/Night	Auto(ICR)/Manual			
White Balance	Auto/Manual/ATW/Indoor/Outdoor/Sodium Lamp/Streetlight/Natural			
WDR	120dB			
Optical Defog	Auto/Manual			
Anti-heatwave	Auto/Manual			
Digital Zoom	16x			
DORI Ratings*	Detection	Observation	Recognition	Identification
	12320m	4889m	2464m	1232m
*The DORI standard (based on the IEC EN62676-4:2015 international standard) defines different levels of detail for detection (25PPM), observation (62PPM), recognition (125PPM), and Identification (250PPM). This table is for reference only and performance may vary depending on the environment.				
Pan/Tilt				
Pan	Range: 360° continuous rotation Speed: 0.1°- 30°/s			
Tilt	Range: -45° to +45° Speed: 0.1°-15°/s			
Positioning Accuracy	0.01°			
Preset	255			
Tour	8, Up to 32 presets per tour			
Scan	5			
Pattern	5			
Park	Preset/Tour/Scan/Pattern			
Scheduled Task	Preset/Tour/Scan/Pattern			
Power-off Memory	Support			
Snap Positioning	Support			
Proportional P/T to Zoom	Support			
Heater/Fan	Integrated, Auto/Manual			
Wiper	Integrated, Manual/Scheduled			

Video and Audio	
Video Compression	H.265/H.264/H.264H/ H.264B/MJPEG
Main Stream	25/30fps (2688 x 1520, 1920 x 1080, 1280 x 720)
Sub Stream	25/30fps (704 x 576, 352x288)
Image Encoding	JPEG, 1-7fps (2688 x 1520)
OSD	Name, Time, Preset, Temperature, P/T Status, Zoom, Address, GPS, Image overlay, Abnormal
Audio Compression	AAC (8/16kHz), MP2L2(16kHz)
Network	
Network Protocols	IPv4, IPv6, HTTP, HTTPS, TCP, UDP, RTSP, RTCP, RTP, ARP, NTP, FTP, DHCP, PPPoE, DNS, DDNS, UPnP, IGMP, ICMP, SNMP, SMTP, QoS, 802.1x, Bonjour
API	ONVIF(Profile S, Profile G, Profile T), HTTP API, SDK
User	Up to 20 users, 2 level: Administrator, User
Security	User authentication, IP/MAC address filtering, HTTPS encryption, IEEE 802.1x access control
Web Browser	IE, EDGE, Firefox, Chrome
Web Languages	English/Chinese
Storage	MicroSD/SDHC/SDXC card (Up to 1Tb) edge storage, FTP, NAS
Analytics	
Perimeter Protection	Line crossing, Fence crossing, Intrusion
Target Distinction	Human/Vehicle/Vessel Classification
Behavioral Detection	Object left in area, Object removal, Fast moving, Gathering, Loitering, Parking
Events Detection	Motion, Masking, Scene change, Audio detection, SD card error, Network disconnection, IP conflict, Illegal network access
Fire Detection	/
Smoke Detection	Support
Strong Light Protection	/
Auto Tracking	Multiple detection tracking modes
Others	Visible/Thermal Synchronized zoom
Interface	
Alarm Input	7-ch
Alarm Output	2-ch
Audio Input	1-ch
Audio Output	1-ch
Ethernet	1-ch RJ45 10M/100M
RJ485	1-ch
General	
Casing	IP 66
Power	48V DC, typical 35, max 80w, DC48V Power adapter included TVS 6000V, Surge protection, Voltage transient protection
Operating Conditions	Temperature: -40℃ to +70℃/-22°F-158°F, Humidity: <95%
Dimensions	393*573*380 mm (W×H×L)
Weight	32kg

Ordering Information

Model No.	Description
VS-PTZ4052YIO-R30	4MP 775mm OIS Long-range Heavy-duty Positioning Camera

Dimensions

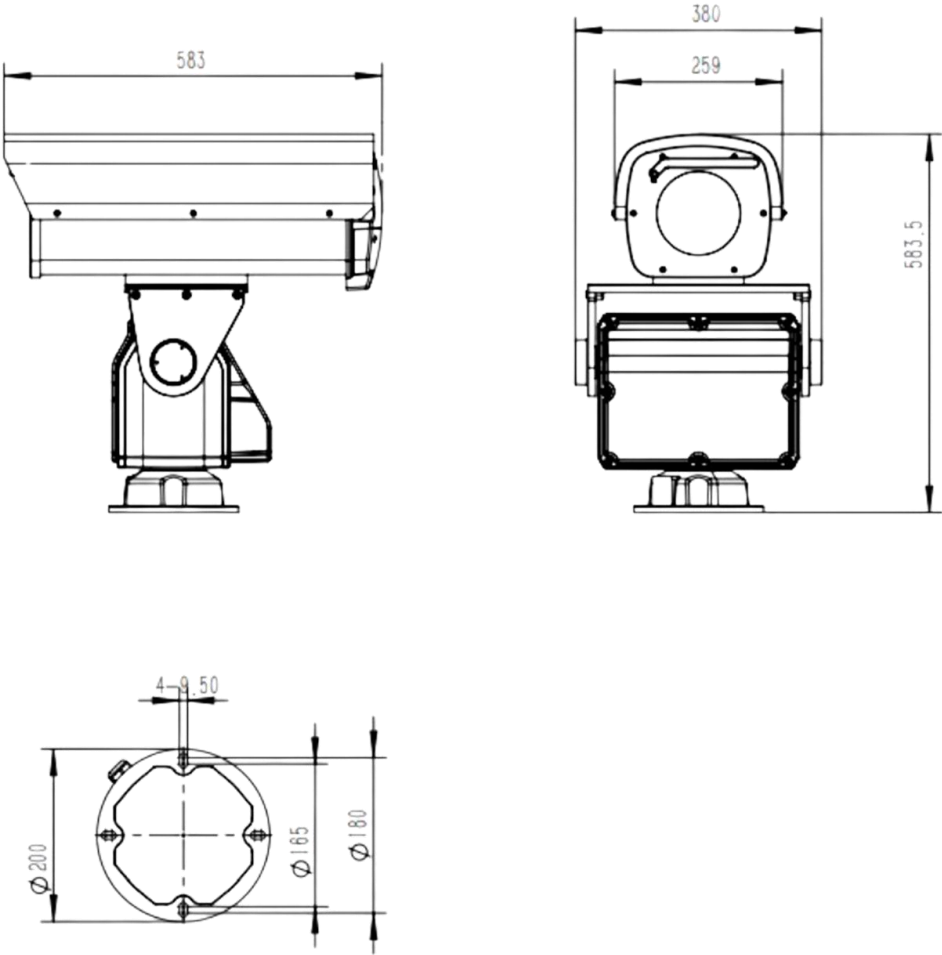

20th Floor, Block 9, Chunfeng Innovation Park
Binjiang, Hangzhou, China
Tel: +86-571-88063872
sales@viewsheen.com
www.viewsheen.com

